

Customer Service Bulletin

SLM Electronics, Saint Louis, Missouri

Dec. 11, 1998

CSB0008

Units Affected:

Model

Serial Number

Audio Centron ACM-8P

A8PDKA0001 through A8PDKA0015

Concern:

Internal cooling fan may be installed backwards, causing the unit to shut down prematurely under heavy operation.

NOTE: To determine if the fan is installed properly, look at the rear panel of the unit. The fan is on the left side, behind a wire shield. If the fan's label is visible (it may be upside down), the fan is facing the proper direction. To confirm this, plug in the unit and turn it on. Verify the fan is blowing air OUT of the unit, NOT drawing air into it. (A properly installed fan pulls heated air out of the unit.)

Corrective Actions:

OPTION A - RETURN UNIT FOR MODIFICATION:

1. To have your unit modified and returned to you, contact the SLM Electronics Factory Service Center at **1-800-738-7563**.

OPTION B - MODIFY UNIT:

1. Tools needed: #2 phillips screwdriver.
2. Unplug the unit.
3. Remove the two screws from each end piece (see photo below). Remove the end pieces.

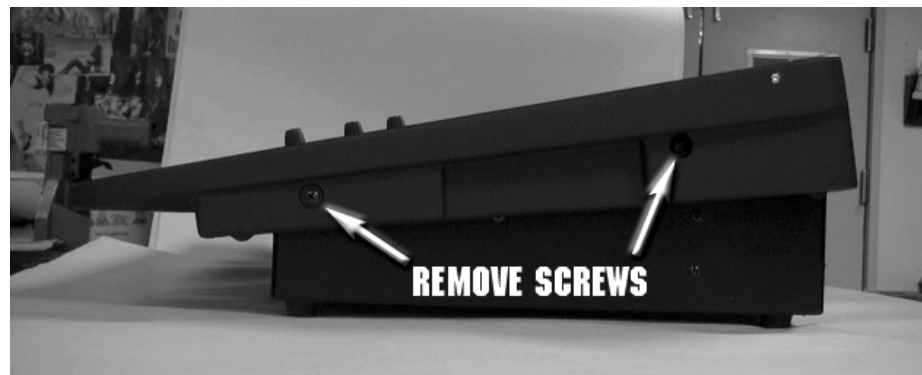

- Carefully flip the unit over. Remove the four screws from along the underside of the unit's front lip (see photo below).

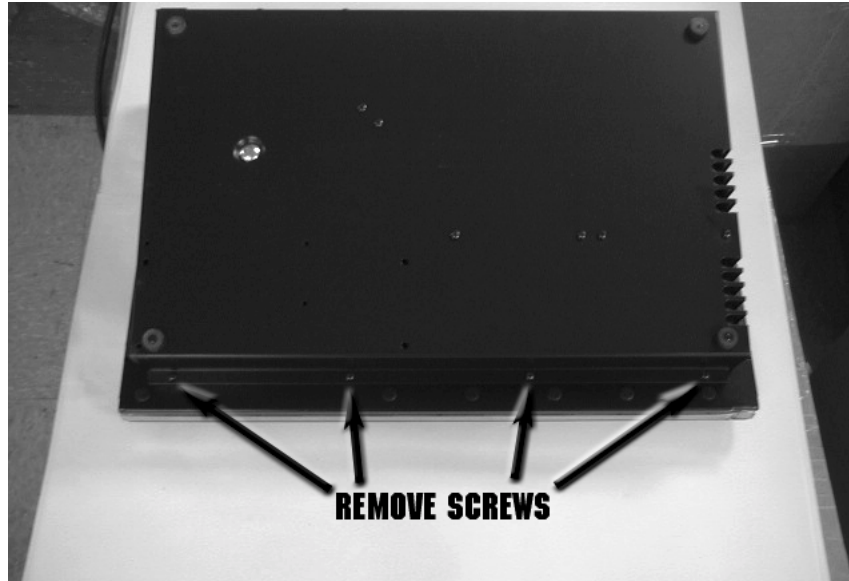

- Flip the unit right side up again and remove the four screws from the top of the rear panel, just below the black trim strip (see photo below).

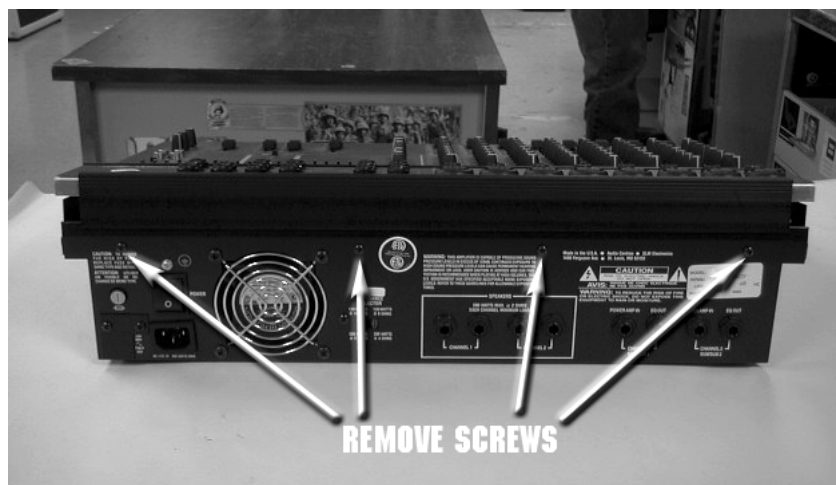

- Carefully lift the top assembly up and away from the bottom chassis - DO NOT stretch the internal wiring harnesses! Gently rest the top assembly on the front half of the bottom chassis (see photo on next page).



7. Remove the four mounting screws from around the cooling fan (see photo below).



8. Lift the cooling fan straight up, out from the bottom chassis, and turn it around (see photo on next page). The directional indicator arrow on the top of the fan should be pointing OUT from the unit.